



American
Society of
Professional
Estimators

Detroit, MI Chapter 17

When: Wednesday February 8, 2012

Time: 5:30 pm – 8:00 pm

Location: DTE - One Energy Plaza, Detroit MI 48226

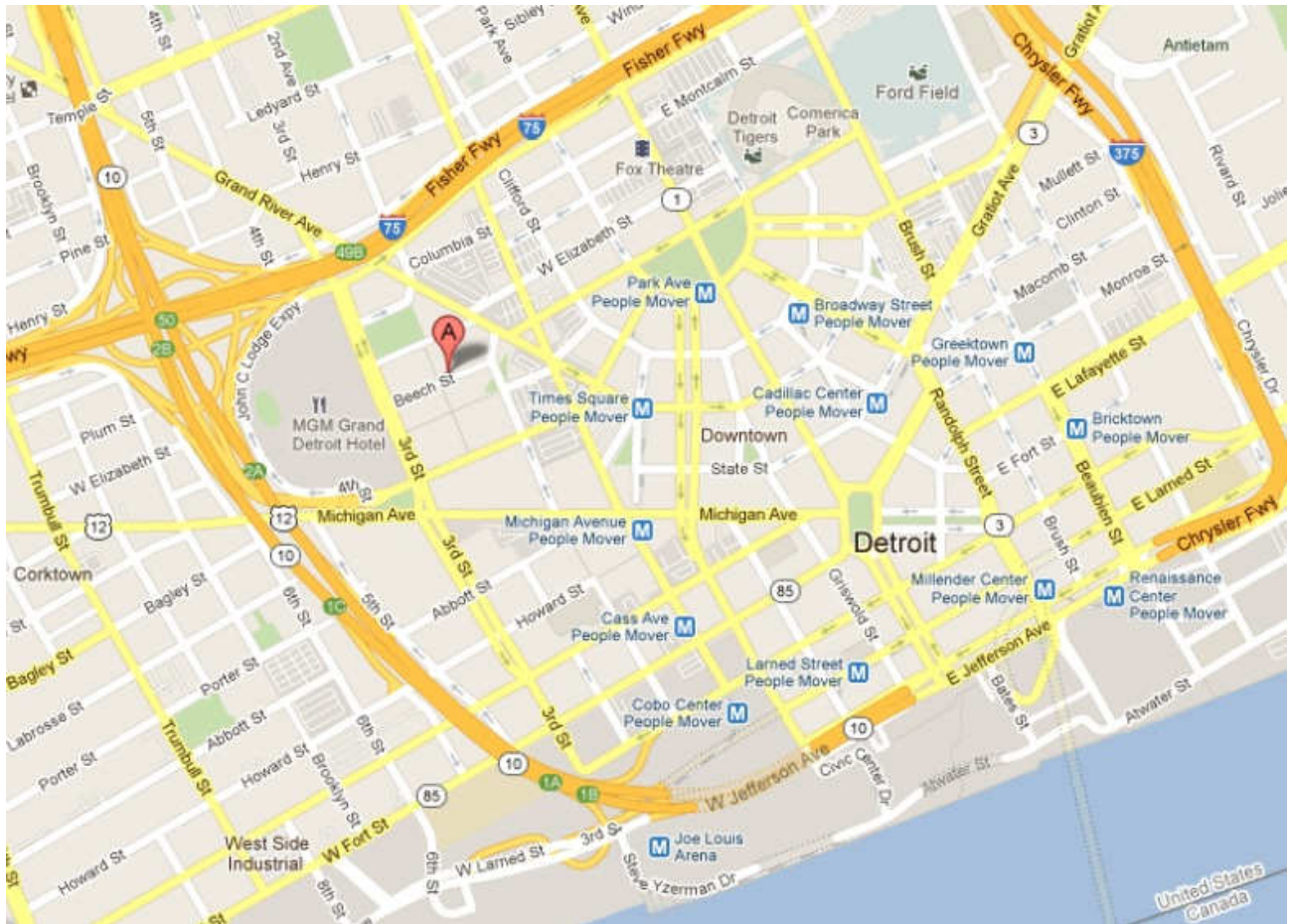

See also next sheet for additional information

Time: 5:30 p.m. food /networking
6:00 p.m. chapter meeting, followed by our
Topic for the night; Presentation on “What DTE Does”

Please RSVP to ajohnston@flooringservices-inc.com by **no later than EOB on Friday 2/3/12** so that I can get a list to our hosts for security purposes. Also let me know if you intend to eat as well. (\$5 cost per attendee if eating)

Legend

-  Pedestrian Walk
-  Covered Pedestrian Walk
-  Revolving door

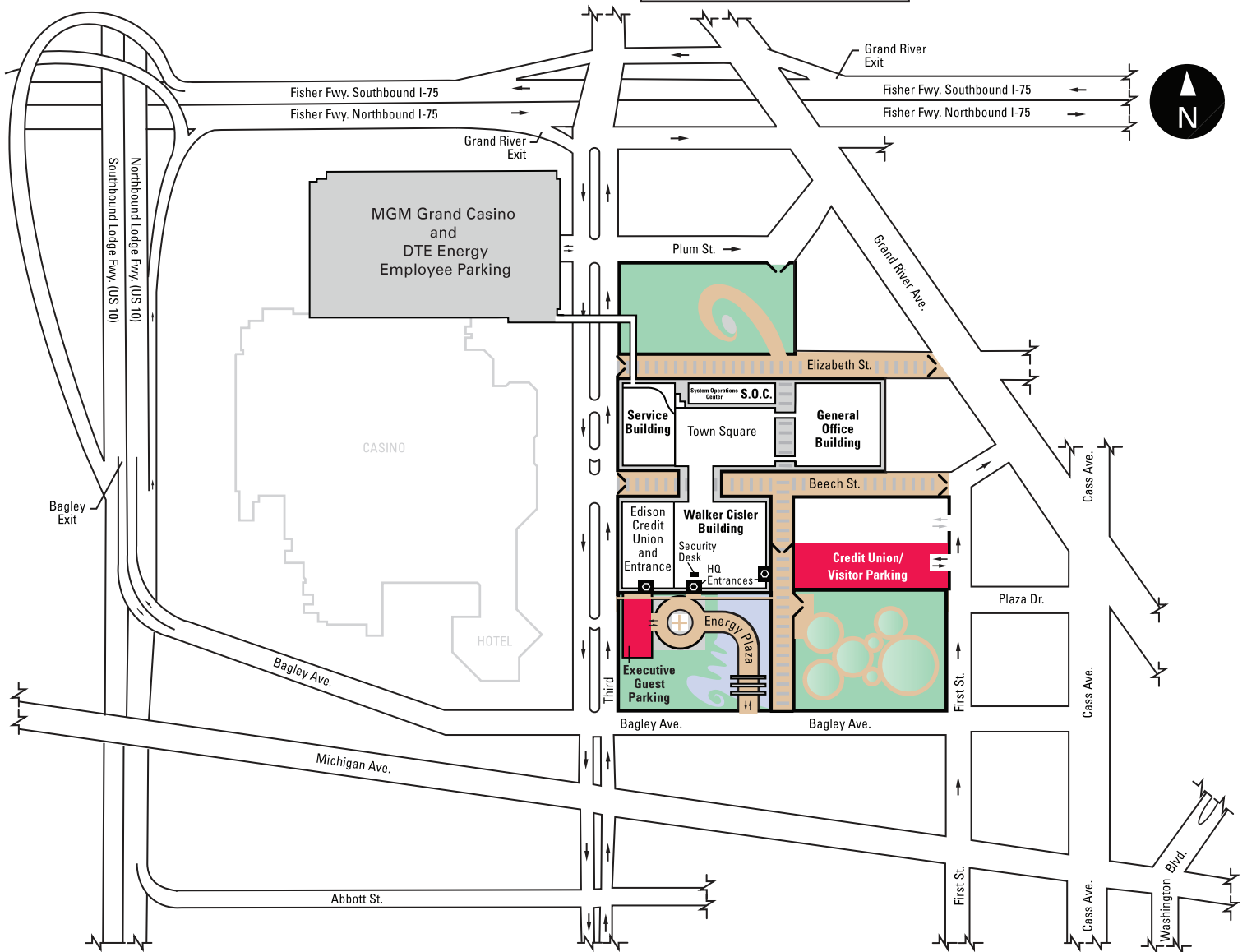

Travel Directions:

- **From Detroit Metro Airport:** Take I-94 East to M-10 South. Exit left at Bagley Ave.
- **From Ambassador Bridge:** After crossing the Ambassador Bridge, turn right on Fort St. Turn left on Third St. Turn right on Bagley Ave.
- **From Detroit-Windsor Tunnel:** After exiting the tunnel, turn right (East) on Jefferson Ave. and then immediately left-turn loop heading West on Jefferson Ave. Continue West on Jefferson Ave. and turn right on Woodward Ave. Veer left on Woodward Ave. around Campus Martius Park and turn right on Michigan Ave. Turn right on Third St. Turn right on Bagley Ave.
- **From the North:** Take I-75 South to the Grand River exit. Remain on the service drive. Turn left on Third St. Turn left on Bagley Ave.
- **From the South:** Take I-75 north to M-39 West to I-94 East. Take I-94 East to M-10 South. Exit left at Bagley Ave.
- **From the East:** Take I-94 West to M-10 South. Exit left at Bagley Ave.
- **From the West:** Take I-96 East, to I-94 East to M-10 South. Exit left at Bagley Ave.

Parking:

- If you are visiting our Executive Offices, parking is available in the **Executive Guest Parking Lot** at the end of Energy Plaza, off Bagley Ave., between First and Third Streets.
- If you are visiting other employees or the Edison Credit Union, parking is available in the **Credit Union / Visitor Parking Lot** off First Street.
- To enter the lots, press the INFO button on the intercom and provide your name and purpose of the visit.

On Arrival:

If you are here for a meeting with a DTE Energy employee, please check in at the **Security Desk** to obtain a visitor ID badge. ID badges are **not** required for Edison Credit Union visitors.